

FRONT SHOCK  
OIL REQUIREMENT –  
.5 Litre or 16 ounces of 20 w 50 Oil

---

REF.	PART NAME	PART NO.	QTY.
1	Front Shock Assembly	1-53-003	2
2	Front Shock Damper Assembly	1-53-005	2
3	Hex Nut Damper Tube	1-53-214	2
4	Combi Slydring	1-53-235	2
5	Damper Piston	1-53-217	2
6	Damper Tube	1-53-218	2
7	Stud, Axle Support	1-53-223	4
8	Socket Head	774024	2
9	Gasket Copper Washer	1-53-220	2
10	Seal	1-53-231	2
11	Slide Ring	1-53-233	2
12	Snap Ring	1-53-209	4
13	Washer	1-53-213	2
14	Washer	1-53-212	2
15	O Ring	1-53-211	2
16	Star Washer	1-53-210	2
17	O-Ring	1-53-203	2
18	Strut Cap	1-53-202	2
19	Strut Plug	1-53-201	2
20	Reservoir Front Shock	1-53-221	2
21	Strut, Front Shock	1-53-207	2
22	Support, Front Axle	1-53-302	2
23	3/8 Stud	1-53-301	2
24	Washer	770324	2
25	Stover Lock Nut	770223	2
26	Mount, Front Caliper	1-58-101	1
27	Spring	1-53-204	2
28	Stover Lock Nut	770823	4
	Front Shock Seal Kit (not shown)	1-53-050	2

*Incl. items 4, 9, 10, 11, & 17*

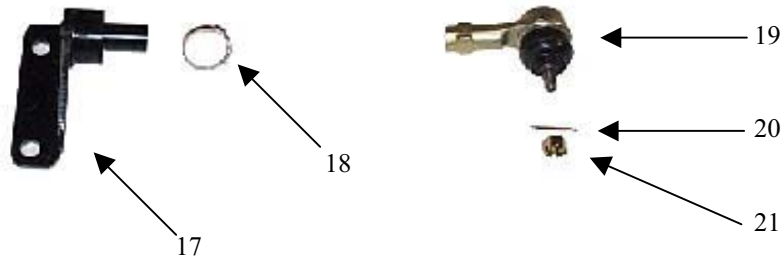
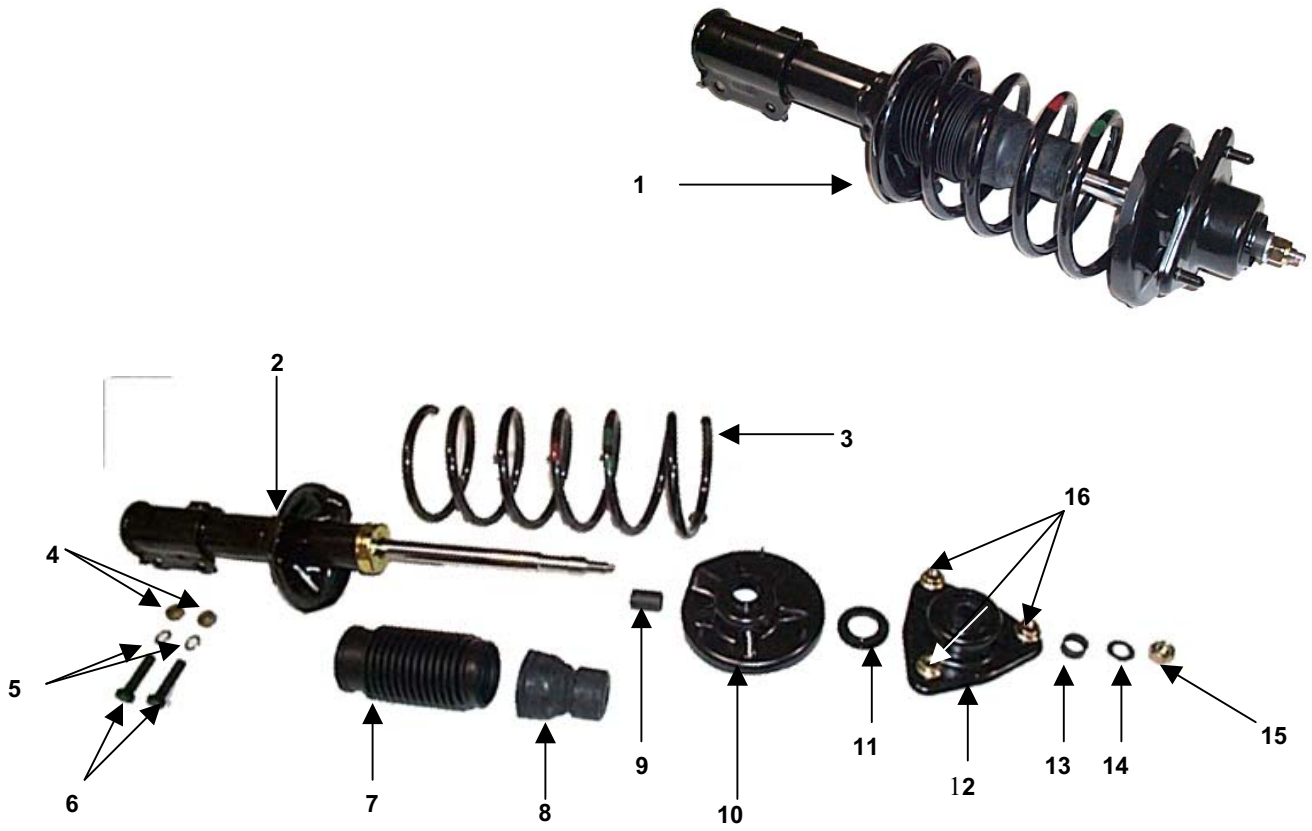

---

<i>REF.</i>	<i>PART NAME</i>	<i>PART NO.</i>	<i>QTY.</i>
1	Rear Strut Assy., RH	1-54-002	1
	Rear Strut Assy., LH (not shown)	1-54-001	1
2	Shock Absorber, RH	54660-02220	1
	Shock Absorber, LH (not shown)	54650-02220	1
3	Coil Over Spring	54630-02100	2
4	Nut	13603-12003	4
5	Lock Washer	13603-12003	4
6	Bolt	11322-12501	4
7	Dust Cover	54625-02000	2
8	Bumper Rubber	54626-02000	2
9	Lower Bushing	1-54-302	2
10	Seat Assembly	54620-02000	2
11	Bearing	54612-02000	2
12	Modified Insulator	1-54-301	2
13	Upper Bushing	1-54-303	2
14	Flat Washer	774205	2
15	Nut	13262-12001	2
16	Nut	13386-1001	2
17	Mount, Tie Rod, LH	1-54-200	1
	Mount, Tie Rod, RH (not shown)	1-54-201	1
18	Boot Clamp	254010	4
19	Tie Rod End	56820-02500	2
20	Cotter Pin	14300-85251	2
21	Slotted Nut	13134-10001	2