

---

REF.	PART NAME	PART NO.	QTY.	VIN#
1	Electrical Panel Lower	1-91-106-60	1	
	Electrical Panel Upper (not shown)	1-91-107-60	1	
2	Flange Lock Nut	771036	4	
3	Hex Head Bolt	771035	4	
5	Circuit Breaker, 20 amp	662916	2	
6	Pan Head Bolt	774237	5	
7	ATM Control Module	95440-02825	1	
8	Computer Assembly	39110-02020		
9	Decal	1-05-206	1	
10	Relay	39160-24540	1	
11	Radiator Support	1-25-110-60	1	
12	Accelerator Sensor	39360-22040	1	
13	Electrical Panel End Cap LH	1-91-108-60	1	
	Electrical Panel End Cap RH, (not shown)	1-91-109-60	1	
14	Bolt	771035	2	
15	LTI Unit	1-91-508	1	
16	Governor Assembly	1-91-507	1	
17	Battery Top Mount	182864	1	
	Heavy Duty Battery (not shown)	2580	1	
18	Pin	25335-07000	1	
19	Power Relay (not shown)	95224-29000	6	
	GRP91 Flasher	95550-33700		
	Battery Clamp	1-91-131-01	1	
	Mat, Battery Tray	1-91-132	1	
	Assembly, Electrical Panel Lid	1-91-011	1	
	Wiring Trays	1-91-117-60	2	

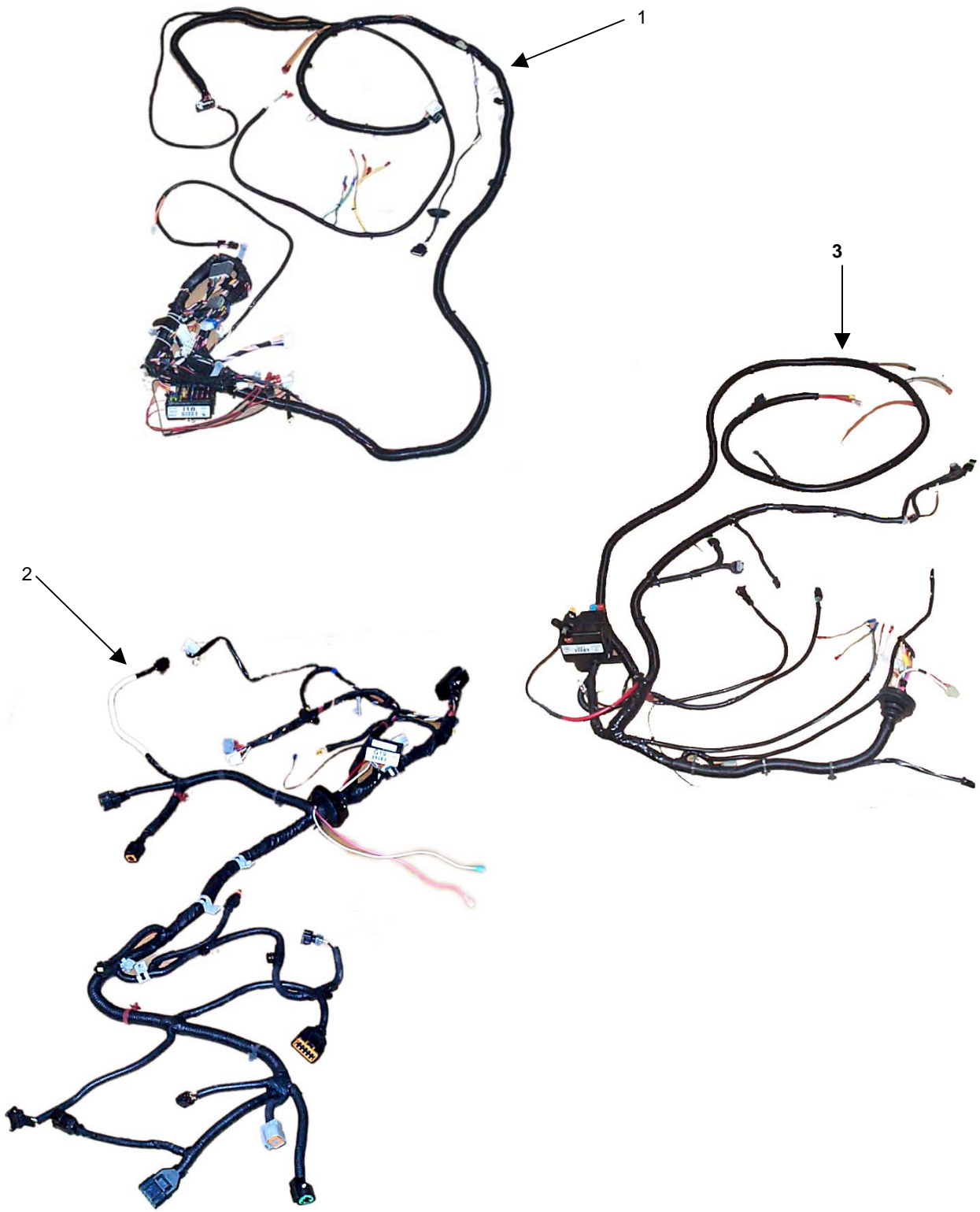

<i>REF.</i>	<i>PART NAME</i>	<i>PART NO.</i>	<i>QTY.</i>	<i>VIN#</i>
1	Control Wiring Harness	1-67-001	1	
2	Main Wiring Harness	1-67-004	1	
3	Engine Wiring Harness	1-67-003	1	
4	Injector Harness (Not Shown)	1-67-002	1	

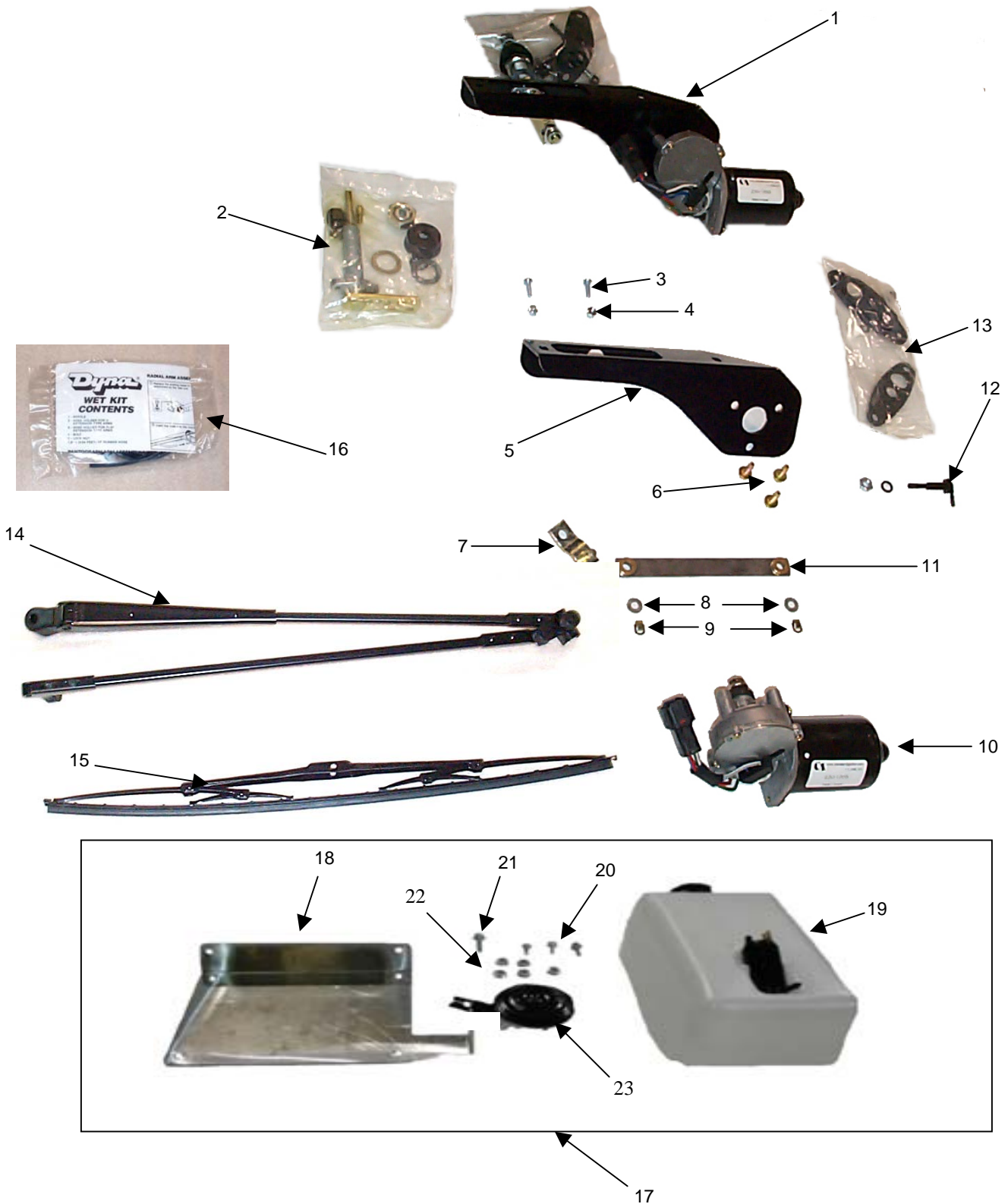

REF.	PART NAME	PART NO.	QTY.	VIN#
1	Windshield Wiper Motor Assy.	1-91-005	1	
2	Pivot Arm	1-91-213	1	
3	Machine Screw	770801	2	
4	Nylon Lock Nut	771778	2	
5	Mounting Plate, Wiper Motor	1-91-101	1	
6	Screws, Wiper Motor	1-91-204	3	
7	Drive Arm, Wiper	1-91-207	1	
8	Washer	644019	2	
9	Spring Clip	1-91-212	2	
10	Wiper Motor	1-91-201	1	
11	Wiper Motor Link	1-91-211	1	
12	Windshield Washer Adapter Assy.	644008	1	
13	Panto Adapter	1-91-208	1	
	SS Phil HD Screw (not shown)	774213	2	
14	Wiper Arm	1-91-209	1	
15	Wiper Blade	1-91-210	1	
16	Wet Kit, Windshield Washer	644031	1	
17	Assembly, washer reservoir	1-91-009	1	
18	Bracket, washer reservoir	1-91-104	1	
19	Bottle, washer	644010	1	
20	¼-NCx1/2 hex head bolt	771035	3	
21	¼-NCx3/4 hex head bolt	770297	1	
22	Flange lock nut	771036	5	
23	Horn	99610-07100	1	
	Assembly, Washer Reservoir (W/O Horn)	1-91-052	1	