

<i>REF.</i>	<i>PART NAME</i>	<i>PART NO.</i>	<i>QTY.</i>	<i>VIN#</i>
1	Dash Assembly	1-84-023	1	
2	Dash Panel	1-84-149	1	
3	Grill, Vent	1-84-106	1	
4	Self Tapping Screw (Not Shown)	771685	3	
5	BRKT, fan control switch (Not Shown)	1-84-119-60	1	
6	BSPS 6-4 3/16 Al rivet w/ steel mandrel	771498	2	
7	Switch, Fan Control	97256-02150	1	
8	Spacer, Hazard Light Switch (Not Shown)	1-84-109	1	
9	Switch, Hazard Light	93360-02000	1	
10	Instrument Cluster Assy.	1-84-024	1	
11	Instrument Cluster	94001-07030	1	
12	Cluster Fascia	84830-07900	1	
13	Bracket, Cluster Fascia LH	1-84-158-60	1	
14	Bracket, Cluster Fascia RH	1-84-159-60	1	
15	Push Tabs (Not Shown)	771098	2	
16	Self Tapping Screws (Not Shown)	774251	6	
17	Plate, VIN label (Not Shown)	1-84-140-01	1	
18	BSPS 4-6 1/8 Al rivet w/ steel mandrel	771497	4	
19	Dash Base Assembly	1-84-018	1	
20	Blower Cable (13.5")	1-97-015	1	
21	Defrost Cable (21 15/16")	1-97-010	1	
22	Shifter Cover Assembly	1-84-010	1	
23	Damper Dash Vent	1-84-117	2	
24	Support Dash Top (Not Shown)	1-84-138	1	
	Access Panel, Wiring Harness	1-84-154-99	1	
	Bracket, Fuse Box	1-91-105-01	1	
	Support, Dash Front RH	1-84-160-60	1	
	Dash Base Assembly (A/C)	1-84-020	1	

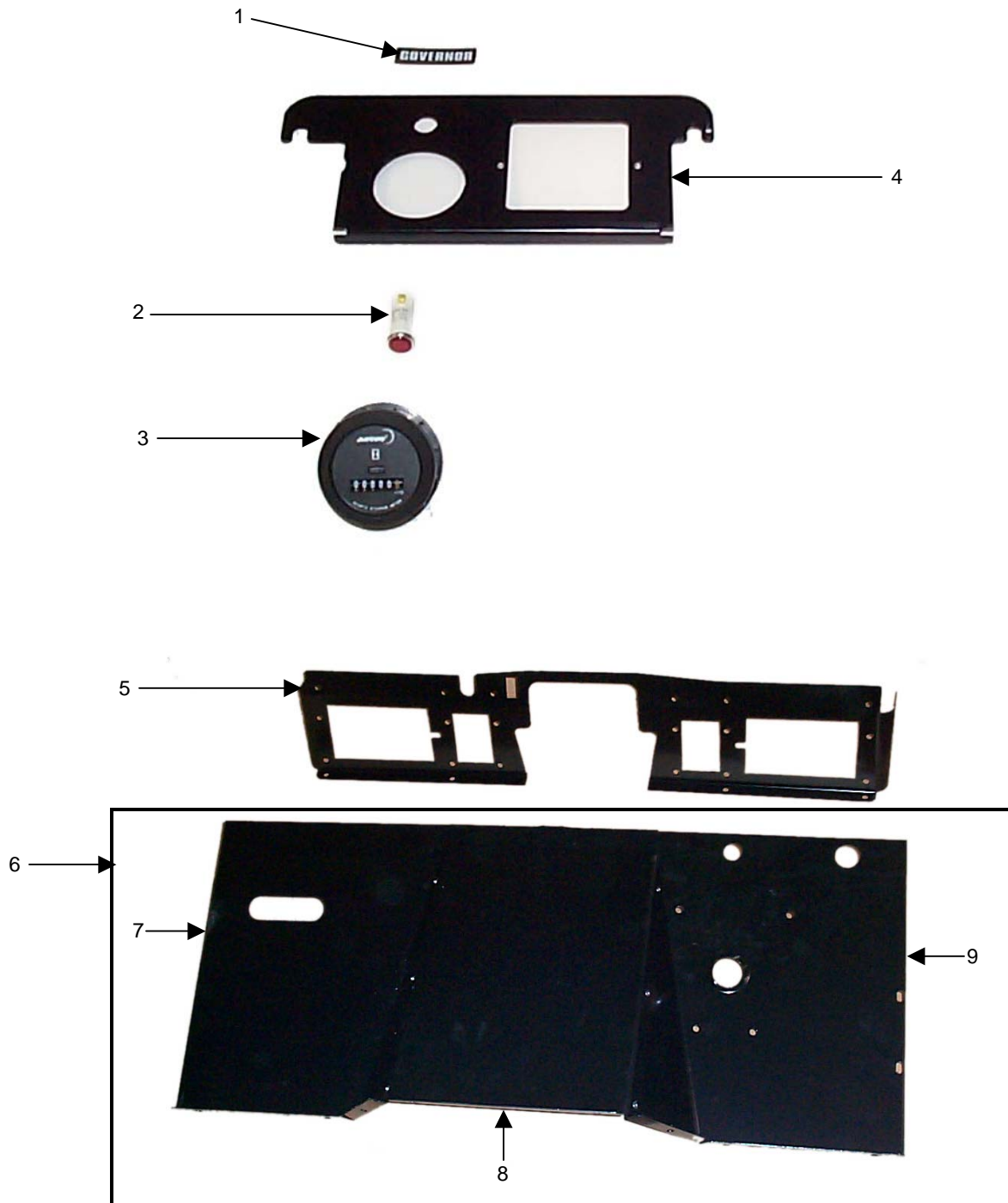

<i>REF.</i>	<i>PART NAME</i>	<i>PART NO.</i>	<i>QTY.</i>	<i>VIN#</i>
1	GOV Decal	1-05-105	1	
2	Red Light, Dash	662043	1	
3	Hour Meter	674138	1	
4	Inspection Panel, Dash RH	1-84-104-01	1	
	Inspection Panel, Dash LH (not shown)	1-84-103-01	1	
5	Panel, Front Dash	1-84-118-01		
6	Console Assembly	1-84-021	1	
7	Panel, Console LH	1-84-121-01	1	
8	Panel, Console Center	1-84-122-01	1	
9	Panel, Console RH	1-84-150-01	1	
	Panel, Light Bar Control (not shown)	1-84-105-01	1	
	Console Assy (A/C) (Not Shown)	1-84-022	1	
	Panel, A/C Intake (Not Shown)	1-84-120-01	1	
10	Digital Hour Meter (Not shown)	674184	1	
	Required Jumper Wires			
	Adapter, Digital Hour Meter	1-91-529	1	

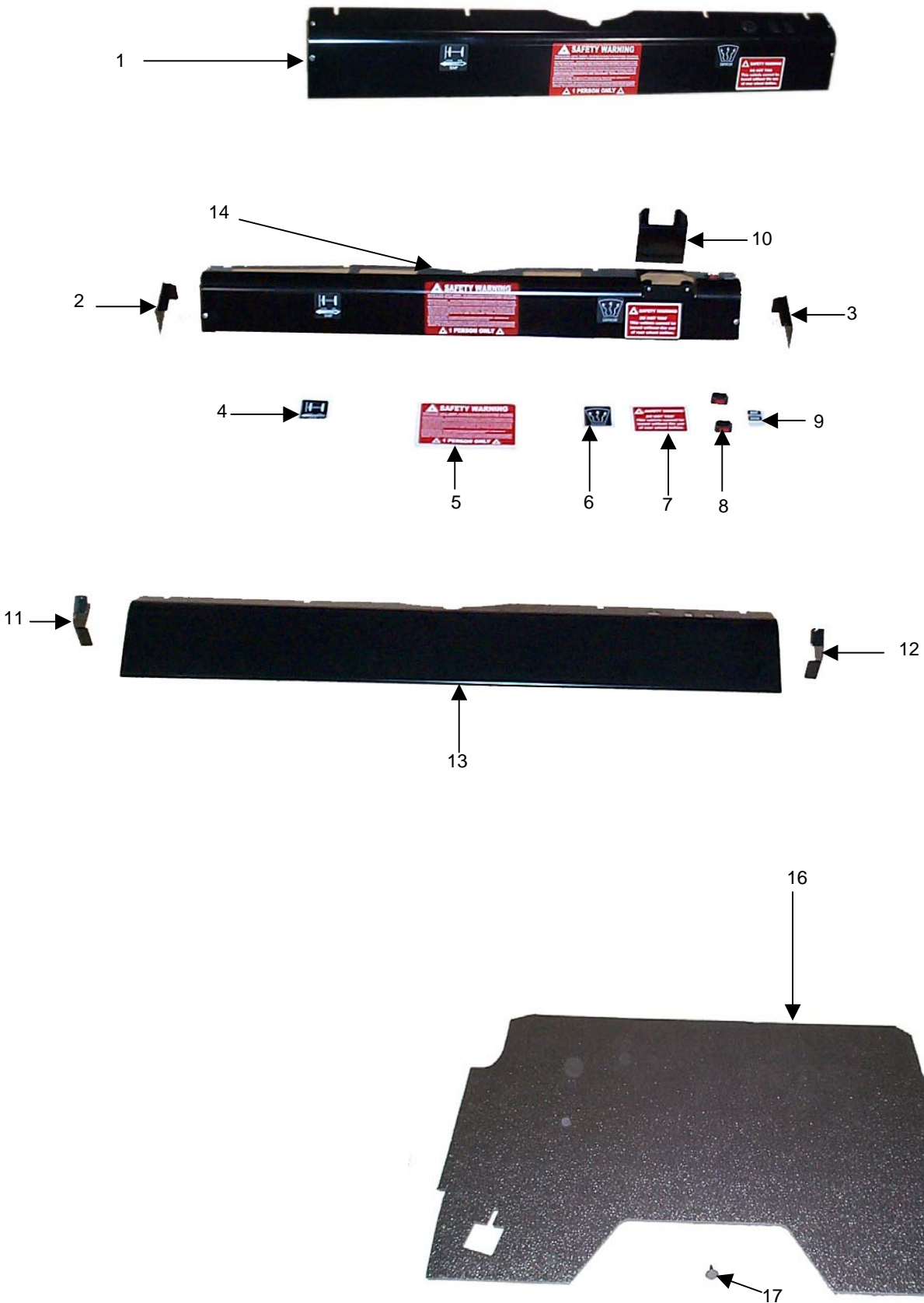

<i>REF.</i>	<i>PART NAME</i>	<i>PART NO.</i>	<i>QTY.</i>	<i>VIN#</i>
1	Lower Dash Cover, Std.	1-84-015	1	
	Lower Dash Cover, Pockets	1-84-004	1	
2	End Cap, Lower Dash LH (SF)	1-84-129-01	1	
3	End Cap, Lower RH (SF)	1-84-130-01	1	
4	Temp Decal	1-05-108	1	
5	Safety Warning Decal	1-05-104	1	
6	Defrost Decal	1-05-109	1	
7	Safety Warning Do Not Tow Decal	1-05-106	1	
8	Illuminated Rocker Switch	662836	2	
9	ROT Decal	1-05-111	1	
10	Ticket Holder	1-84-134	1	
11	End Cap, Lower Dash LH	1-84-125-01	1	
12	End Cap, Lower Dash RH	1-84-126-01	1	
13	Cover, Lower Dash	1-84-127-01	1	
	Plug (not shown)	850009	1	
	Accessory Power Plug (not shown)	850008	1	
14	Cover, Lower Dash (SF)	1-84-128-01	1	
15	Floor Mat	1-84-202	1	
16	Push Button	771099	20	